

● 熱水爐的周圍條件及各安裝距離如下圖所示：

Surrounding conditions for the water heater, The distance for installation is show in the following drawing:

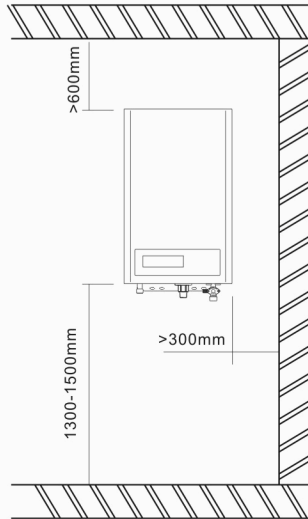

背出式燃氣熱水器的安裝 BACK FLUE INSTALLATION METHOD

1. 在牆壁上,熱水爐下方75mm處開1個Φ160-Φ180mm的孔, 如圖A

Drill a Φ160-Φ180mm hole 75mm under the top plate of the water heater on the wall as drawing A.

2. 按下圖固定板上的4個Φ8mm孔的尺寸, 在穿牆孔周圍的牆壁上鑽4個Φ8mm的小孔, 然後打入膨脹膠塞。

Drill four Φ8mm holes on the ambient wall of the through wall hole according to the dimension of the four Φ8mm holes on the fastening board as the right drawing the plug into them.

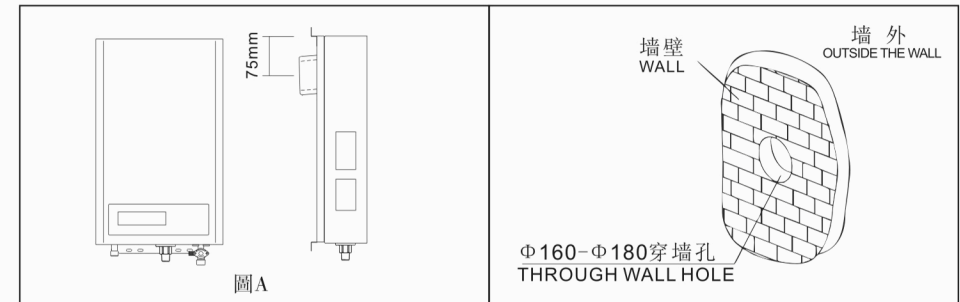

3. 將排氣管穿入固定挂板內,用4個M4的螺釘固定。

Put the flue through the fastening board and fix it with four M4 screws.

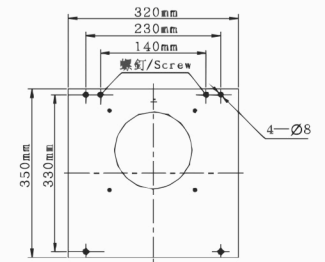

4. 把排氣煙管穿入過牆孔內,和自攻螺釘把煙管固定在牆壁上。

Put the flue through the through wall hole and fix it with self-tapping screws.

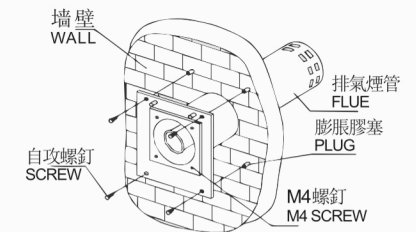

5. 熱水爐煙道末端距離A、B、C、D 4個方向300mm範圍內不能有障礙物。

There cannot be obstacles within the area of 300mm from direction A, B, C & D.

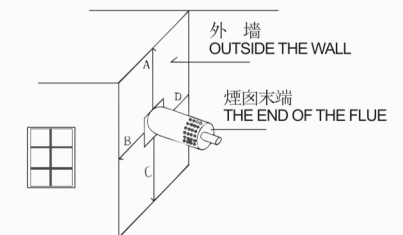

6. 用防水材料堵塞牆孔與排氣管之間的空隙，防止雨水滲入室內。安裝排氣管必須稍微向下傾斜，以防止雨水從排氣管滲入熱水爐。此熱水爐祇適合安裝於厚度小於300mm以下的牆壁。

Fill up the gap between the wall and the flue with waterproofing material so that the rain cannot permeate into the room. Make sure that the flue has a downward inclination when installed to prevent the rain from permeating into the water heater. The water heater can be installed only on walls with thickness of less than 300mm.

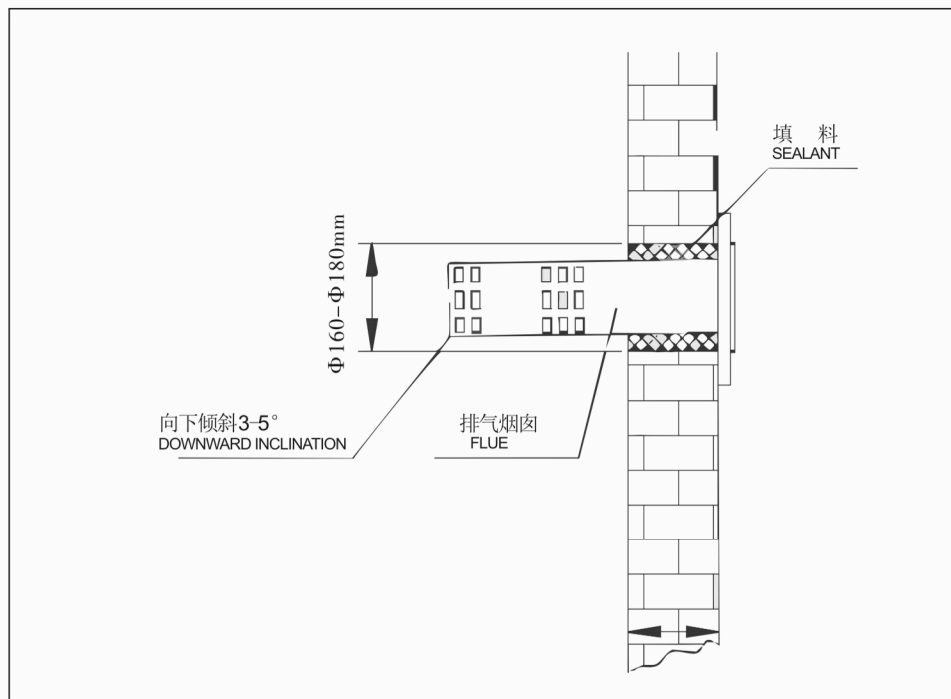

7. 在牆上頂碼小孔之下585mm處鑽兩個小孔並打入膠塞，用來固定熱水爐底碼。把熱水爐掛在固定掛板的兩個螺絲上，用螺絲鎖緊。另用螺絲把底碼固定在牆壁上。

安裝時必須確保熱水爐之排氣口已套入排氣管內。

Drill two holes on the wall (585mm under the top panel holes) and drive the plug into them. Hang the water heater on the two screw stems of the fastening board and fix it with screws. Besides, fix the back panel with screws on the wall.

Notes: Make sure that the exhaust vent of the water heater is inserted into the flue when installed.

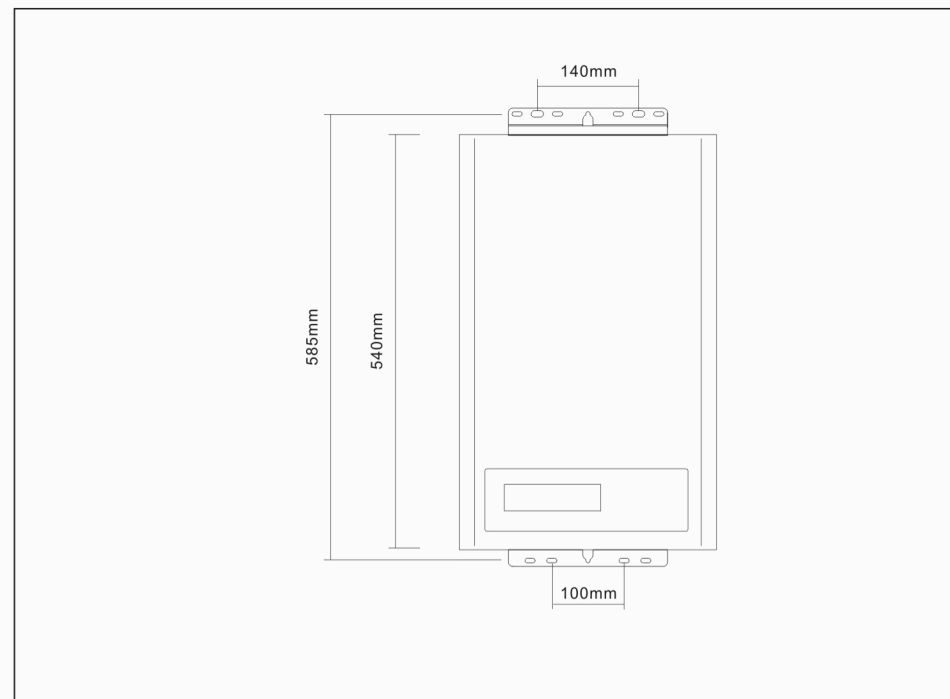

頂出式燃氣熱水器的安裝 TOP FLUE INSTALLATION METHOD

2. 主體安裝 The installaton of the main body

按較示尺寸在牆壁上打3個孔，并在孔上固定膨脹螺栓。然後掛上熱水爐，再用膨脹螺釘固定好。

Drill three holes on the wall accordingly to the dimension as the drawing shows and fix the plugs on them hang the water heater and fix it with screws.

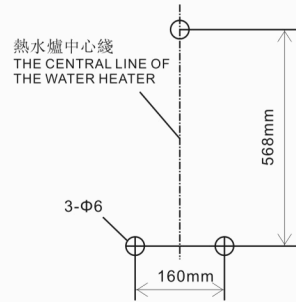

頂出式&背出式燃氣熱水器接头的安裝 TOP FLUE & BACK FLUE GAS WATER HEATER JOINTS INSTALLATION

水 WATER		燃氣 GAS		
冷水 COLD	熱水 HOT	石油氣 LPG	天然氣 LNG	煤氣 TG
G1/2	G1/2	G1/2	G1/2	G1/2

1. 冷水管的連接 Connection of cold water pipe

熱水爐冷水接頭規格是G1/2管螺紋。進水管最好用金屬軟管連接，也可用水管連接閥門（供水主閥）。進水管前須裝上控制閥門（供水主閥），注意避免冷水接頭中的過濾網堵塞。

The cold water joint of the water heater uses G1/2 pipe thread. It's better to connect the inlet tube by using metal hose or to connect the valve by using water tube (main water-supply valve) shall be installed upstream of the inlet tube. Please pay attention to avoiding clogging of the filter in the cold water joint.

2. 熱水管的連接 Connection of hot water pipe

熱水爐出水接頭規格是G1/2管螺紋。供熱水管的長度應盡量短，盡量減少拐彎，因為供熱水管長和拐彎多會影響該熱水爐的啟動水壓，樓層高的和水壓偏低的用戶會更明顯。熱水爐可用金屬軟管連接（長度盡量短些），也可用水管直接連接，如圖所示。如用水管供熱水時，宜用脫氧銅管或不銹鋼。如需要遠距離供熱水時，最好在熱水管上裝控制閥門。

The hot water joint of the water heater uses G1/2 pipe thread. The hot water pipe shall be as short as possible, and shall keep the number of bends at the minimum, because long hot water pipe and lots of bends will affect the startup water pressure of the water heater. This is especially obvious for users living at high floors or having low water pressure. Hot water pipe can use metal hose (as short as possible) for connection or water tube for direct connection as shown in the drawing. It's better to use deoxidized copper pipe or stainless steel pipe for hot water supply. If hot water supply is needed for a long distance, it's better to install a control valve on the hot water pipe.

頂出式燃氣熱水器的安裝 TOP FLUE INSTALLATION METHOD

1. 平衡烟管的安裝

- 必須使用本熱水爐所配的專用對衡烟管。
- 禁止安裝其他形式或規格的烟管，不得對烟管進行自行改造。
- 在牆或窗適當位置鑽1個大于 $\Phi 100\text{mm}$ 的孔（距離天花板300-430mm的範圍內），將對衡式烟管由裏向外套入，外露烟管長度不小于100mm。接着套入裝飾蓋，以封住空隙。然後用吊箍箍緊烟管并調整烟管位置，保持烟管水平傾斜3-5°，最後將熱水爐和平衡烟管連接起來，再用夾箍箍緊。

● 如要加長烟管，請選購專用的排烟對衡烟管。但最長不能超過2m（從A點到C點），及最多祇能配置2個彎頭。

- 烟道與其穿過的圓孔之間間隙不得用水泥類東西填充，否則不易維修。

注意：1.排氣口的最低高度不低於熱水爐頂部高度。

2.不得將對衡烟管裝入共用烟道內。

1. The installation of the balance flue

- Must use the assorted specialized balance flue for the water heater.
- Flue of other types or specificatio shouldn't be used and the flue should not be modified by oneself.
- Drill a hole of more than $\Phi 100\text{mm}$ at the suitable position on the wall or window (within a distance of 300-430mm from the ceiling). Insert the balance flue from inside, and the length of the flue exposed outside should be no less than 100mm. And then fill up the gap with the decoration cover. After that, tighten the flue with the hanging hoop and adjust it's position to kep it with a horizontal inclination of 3-5°. Finally, connect the

water heater and the balance flue and tighten them with hoop.

- If the flue needs to be lengthened, please buy the specialized balance flue. But the maximum of the length must be no more than 2m (from point A to C) and can be equipped with two elbows at most.
- The gap between the flue and the hole should not be filled up with something like cement, otherwise the repairing would be difficult.

Note: 1. The minimum height of the through-wall hole should not be lower than that of the top of water heater.

2. The balance flue should not be inserted into the common flue.

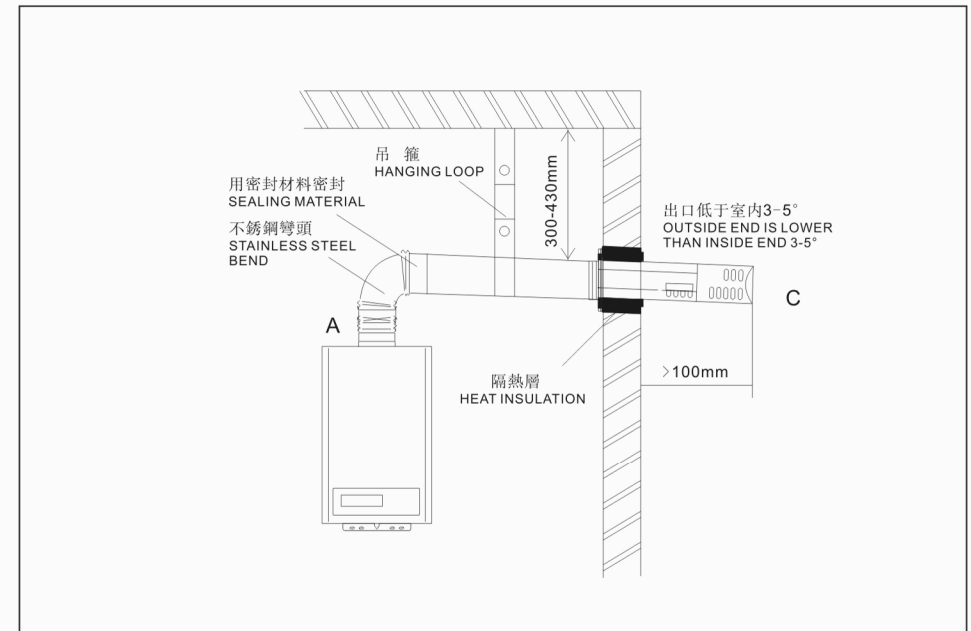

3.燃氣管的連接 Connection of the gas pipe

● 熱水爐進燃氣接頭為G1/2管螺紋。當使用液化石油氣時，先將燃氣軟管接頭接到熱水器燃氣管接頭上（注意一定要裝上橡膠密封圈），然後用內孔為Φ9.5mm的燃氣專用橡膠軟管連接，一端液化石油氣罐的減壓閥出口，一端插入熱水器進氣口的軟管接頭上，直至軟管套至接頭的凹槽為止，并用管夾夾緊。

The gas inlet joint of the water heater uses G1/2 pipe thread . If liquefied petroleum gas inlet hose joint with the gas pipe joint of the water heater (Please note that rubber gasket must be mounted). And then connect the special gas rubber hose whose inner diameter is Φ9.5mm , one end of the rubber hose is connected to the outlet of the pressure relief valve on the liquefied petroleum gas tank, and the other end is connected to the hose joint of the gas inlet of the water heater until the hose is at the groove position of the joint . And the connection shall be tightly fixed with pipe clip.

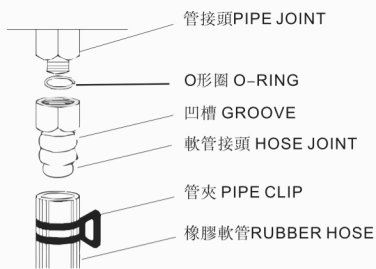

● 使用人工煤氣時，應用銅接頭進行連接。并安裝燃氣閥門，其閥門通徑大于Φ9.5mm。

If pipeline gas is used , please use copper joint for connection and install a gas valve whose inner diameter should be larger than Φ9.5mm.

● 燃氣入口接頭接好後，打開供氣閥門，用肥皂水測試該接駁處有否漏氣。

After the gas inlet joint is connected , open the gas valve and check whether there is gas leakage at the joint with suds.

安裝完成后之測試流程
AFTER INSTALLATION WORK COMPLETED

檢查及測試項目 Check & Test Item	檢查及測試內容 Check & Test Particulars
燃氣種類 Type of Gas	燃氣種類是否符合銘牌要求 To meet gas type requirement on instruction plate
使用交流電源要求 Electric AC V/Hz	交流電源是否符合220V/50Hz To meet electric power AC220V / 50 Hz
防火要求 Fire Prevention Requirements	安裝位置是否符合防火要求 Installing locations to meet fire prevention requirement
安裝條件要求 Installation Standards Requirements	與障礙物距離要適當 Where no hindrances to keep distance with opening
維護保養工作空間 Space for repairs work	需留有必要的維護保養空間 To keep enough space for repairs work
安裝穩固性 Stability installation	安裝必須穩定牢靠 Stable installation work requirement
烟囱 Air inlet & exhaust	烟囱規格是否符合說明書要求,安裝牢固,符合末端距離要求 To meet flue installation surrounding conditions requirement
冷熱水管 Cold & Hot Water Piping	冷熱水管尺寸材質是否符合要求，是否有漏水現象 Water tap , pipe size materials required OK Leakage or not
燃氣管 Gas supply piping	燃氣管材質及尺寸是否符合要求,細心做好漏氣檢查 Gas pipe size material required Gas leakage check carefully
電源連接 Electric wiring work	按當地電氣安全法規要求連接電路,確認地綫是否連接可靠 All the electrical condition must comply with the local requirements Make sure to connect earth cord OK
點火測試熱水器 Test water heater	依使用說明書的指引進行熱水器常規測試; 測試完畢後,關閉燃氣閥門、水閥及電源。
向用戶詳細說明使用方法 Use the method in detail to the user	將使用說明書交給用戶細心閱讀; 詳細解釋使用方法與步驟、日常檢查、安全檢查及清潔工作。

日常保養須知

- 經常檢查供氣管道（軟管）是否完好，有無老化，裂紋。注意定期更換軟管，請經常用肥皂水在軟管接駁處檢查有無氣泡出現，判斷是否不漏氣，設法制止漏氣。
- 經常注意有無漏水現象以便及時處理。
- 經常用濕布把外表面的臟物，污垢等擦淨，然後用幹布抹幹，不易清除的污物可用中性洗滌劑擦除。
- 排氣管各部位應保持暢通，嚴禁堵塞烟道。
- 清潔排烟道時，請切斷電源。

INSTRUCTIONS FOR DAILY MAINTENANCE

- Check the gas supply pipe (hose) regularly to see if it is in good condition , or if there is aging or crack on the hose . Replace the hose regularly . Please frequently use soap water to check the joints of hose to see if there is bubble , so as to find out if there is gas leakage on the joints . Find a way to stop the leakage if it is found .
- Please regularly check if there is water leakage so as to make timely treatment.
- Please regularly clean the surface of water heater body to remove dirt or dust with wet cloth , and then dry it with dry cloth . For the dirt that is not easy to remove , Please use neutral detergent to wipe it off .
- Keep each section of the exhaust pipe clear so as to ensure the smooth discharge of exhaust gas .
- Please cut ff the power supply before checking the exhaust flue.

非熱水器本身故障的不正常現象

以下是正常現象，熱水爐並無故障發生

原因	現象	有水蒸汽產生	熱水白色有混濁	烟窗外出現白色烟霧	處理方法
	熱水溫度調節在高溫位置	●	●		按下熱水溫度調節鍵(▼)回至中溫或低溫溫度
	空氣溶入水中受熱產生氣泡	●	●		放熱水片刻後氣泡會自動消失
	天氣寒冷地帶排出烟氣中的水蒸汽			●	并非故障 不需處理 但須嚴重注意給排氣烟道有無被污物堵塞，如有，請立即清除之

故障代碼識別

若熱水器出現故障，溫度控制器會顯示出故障代碼符合，用戶得知後應關閉電源、燃氣閥門及水龍頭。請立即致電本公司售後維修電話，報告故障代碼，進行維修工作。

故障代碼	故障內容	故障原因	處理方法
E1	風機故障	風機轉速異常 控制系統故障	檢查及清潔風機 檢查控制系統
E2	進水溫度傳感器故障	進水溫度傳感器開路或短路 控制系統故障	檢查進水溫度傳感器 電線連接處 及控制系統
E3	出水溫度傳感器故障	出水溫度傳感器開路或短路 控制系統故障	檢查出水溫度傳感器 電線連接處 及控制系統
E4	過熱故障	熱水溫度>93℃ 溫控制器或熱融斷器斷開	檢查出水溫度傳感器 檢查溫控制器及熱融斷器 檢查比例閥和控制系統
E5	燃氣閥故障	燃氣閥輸出電路異常	檢查燃氣閥電路 檢查連接端子 檢查控制系統
E6	點火失敗	燃氣供應故障 冷水流量感應系統故障 電氣線路故障	檢查燃氣壓力、供應量、電磁閥、比例閥；檢查供水壓力、水流量、水流傳感器；檢查打火針、感應針；檢查控制系統
E7	假火故障	火焰檢測電路異常	檢查火焰檢查電路
E9	意外熄火	燃氣供應故障 電氣線路系統故障	檢查感應針 檢查燃氣供應系統
EB	殘火故障	燃氣閥門關閉不嚴 感應針故障	檢查感應針 檢查燃氣閥門是否關閉不嚴
EC	通信故障	通信中斷或信號異常	檢查遙控器導線連接 檢查控制系統

The following errors are not caused from the water heater

Symptoms Possible Causes	Symptoms			Remedies
	Vapour In the hot Water	Turbid Hot water	White mist In the outlet Of flue	
Hot water temperature Controller on high Temp. Position	●	●		Turn on to Middle temperature Position
Foamy air in the Water caused by High temperature	●	●		Open hot water tap Keeping a few minutes
Freezing steam In the waste gas in The Winter in the Cold place			●	No error Never mind Please check the balanced flue regularly and keep clean.

If the water heater is out of order, a number is automatically showed on the display of main controller and remote controller. The number represents one of error codes. After the user knows what error code it is, disconnect the electric current and also turn off the gas cock and the hot water tap. The user must call the dealer and report the error code immediately. The repairs will be done accurately, conveniently, and quickly.

Failure Code	Failure Description	Failure Cause	Processing Methods
E1	Fan Failure	1) Fan runs abnormally 2) Controller system failure	1) Check and clean the fan 2) Check the controller system
E2	Inlet Water Temperature Sensor Failure	1) Inlet water temperature sensor is in the open or short circuit 2) Controller system failure	1) Check the inlet water temperature sensor 2) Check the wire connection points and controller system
E3	Outlet Water Temperature Sensor Failure	1) Outlet water temperature sensor is in the open or short circuit 2) Controller system failure	1) Check the outlet water temperature sensor 2) Check the wire connection points and controller system
E4	Over-heating Failure	1) Temperature of hot water is > 93℃ 2) Temperature controller or thermal melt device is disconnected	1) Check the outlet water temperature sensor 2) Check the temperature control device and thermal melt device 3) Check the proportional valve and controller system
E5	Gas Valve Failure	Output circuit of gas valve is abnormal	1) Check the circuit of gas valve 2) Check the connecting terminals 3) Check the controller system
E6	Firing Failure	1) Gas supply is failure 2) Cold water volume sense system is failure Electricity is failure	1) Check the gas pressure, volume, solenoid valve and proportional valve 2) Check the water pressure, volume, water-flow sensor 3) Check fire needle, sensor needle 4) Check the controller system
E7	False-Fire Failure	Flame detecting circuit is abnormal	Check the flame detecting circuit
E9	Accidental Extinction	1) Gas supply is failure 2) Electricity circuit system is failure	1) Check the induction needle 2) Check the gas supply system
EB	Residual Fire Failure	1) Gas valve is not closed completed 2) Induction needle is failure	1) Check the induction needle 2) Check if the gas valve is not closed completed
EC	Communication Failure	Communication is interrupted or the signal is abnormal	1) Check the connection of remote control wire 2) Check the controller system

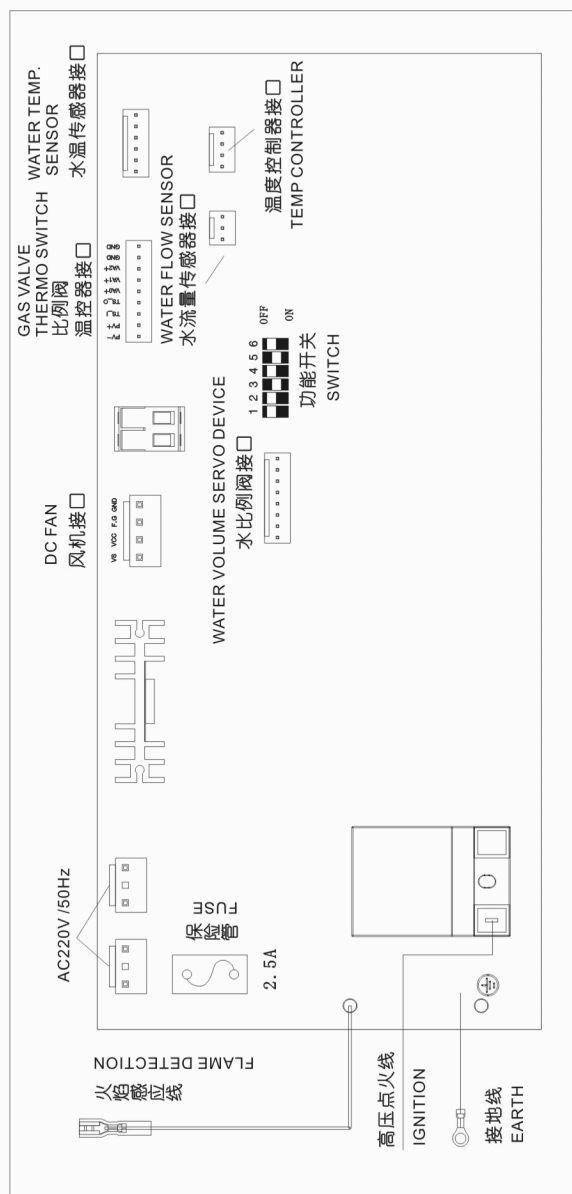

功能定义	开关位数	ON	OFF
循环预热	SW1	有	无
机型选择	SW2		
参数锁定键	SW3	可调节	锁定
气种选择	SW4		
气种选择	SW5		
机型选择	SW6		

FUNCTION	SWITCH	ON	OFF
CIRCULATING HEATING	SW1	YES	NO
MODEL SELECTION	SW2		
LOCK	SW3	NO LOCK	LOCK
GAS TYPE	SW4		
GAS TYPE	SW5		
MODEL SELECTION	SW6		

气种	开关	SW4	SW5
天然气	OFF	ON	
液化石油气	OFF	OFF	
人工燃气	ON	OFF	

SWITCH GAS TYPE	SW4	SW5
NG	OFF	ON
LPG	OFF	OFF
TG	ON	OFF

机型	开关	SW2	SW6
11L	ON	ON	
12L/13L	OFF	ON	
16L	ON	OFF	
20L	OFF	OFF	

SWITCH MODEL	SW2	SW6
11L	ON	ON
12L/13L	OFF	ON
16L	ON	OFF
20L	OFF	OFF

如你所用的熱水爐有異常情況，不能正常使用時，請按“故障與處理方法”逐項進行檢查。如處理不好或仍有不明白的地方，請不要自己隨便拆開修理，應與我公司的特約維修部或我公司售後服務部聯系。

您也可以寫信來本公司售後服務部直接聯系，函告時請告知下述內容：

1. 產品名稱、型號
2. 出現的現象（盡量詳細些）
3. 過程

本公司將會為你做出詳盡的服務，令稱心滿意。

裝 箱 單

1.熱水器本體	1臺	
2.燃氣入口軟管接頭	1個	（LPG型）
3.安裝螺釘	3個	
4.安裝螺釘	3個	
5.使用說明書	1本	
6.產品維修卡	1張	
7.平衡烟管、不銹鋼彎頭、吊箍	1套	（頂出式熱水爐用）
8.背板、背出式烟窗	1套	（背出式熱水爐用）

If abnormal situation occurs and the water heater cannot be used normally, please check item by item according to the section "Failure & troubleshooting". If there is any problem cannot be handled or understood, please contact the appointed maintenance department or customer service department of our company instead of taking it apart to ment it by onself.

You can also directly contact the cusomer service department of our company by mails providing the following information:

1. Name and model of the product
2. Description for the problem (in detail)
3. The process

Our company will provide you extensive services and make you satisfied.

PACKING LIST

1. Water heater body	1pc	
2. Gas inlet hose joint	1pc	（LPG）
3. Sprayer	3pcs	
4. Mounting screws	3pcs	
5. Instruction manual	1pc	
6. Prouct warranty card	1pc	
7. Balance flue, stainless steel bend, hanging hoop	1set	（TOP）
8. Back plate, Back flue	1set	（BACK）

警告WARNING

安裝爐具必須由專業註冊氣體技工安裝，並須使用合格之喉管及配件，否則一切後果本公司及代理商概不負責，不可自行安裝。

The guarantee will be rendered invalid if the cooking range is not installed by licensed installer (RGI), and approved piping and accessories must be used.

石油氣爐具接駁：

使用膠喉管接駁：請使用合格印有機電工程署批准登記。

（例如：“機電工程署批准EMSD APPROVAL GTXXXX或GSO-RT-2”字樣）之膠喉接駁及氣掣進行接駁，由爐底1/2"PT喉牙接駁至供氣點。

LPG Gas connection:

Tubing connection: please use copper piping or approved rubber tubing bearing EMSD approval making (such as "機電工程署批准EMSD APPROVAL GTXXXX 或GSO-RT-2" accessories and gas cook for connection from 1/2" PT connector up to gas point.

煤氣接駁：

請使用合格印有機電工程署批准標記（例如：“機電工程署批准EMSD APPROVAL GTXXXX”字樣）之不銹鋼喉及氣掣進行接駁，由爐底G1/2"喉牙接駁至供氣點。

Town Gas Connection:

Please use approved stainless steel braided flexible tubing EMSD Approval making (such as "機電工程署批准EMSD APPROVAL GTXXXX" And gas cook for connection . Connection from G1/2" connector to governor, and connect up to gas supply point.

警告WARNING

根據香港法例第51章氣體安全規定，任何氣體配件（包括接駁軟喉）的安裝/更換必須由香港政府註冊氣體工程承辦商/註冊氣體安裝技工負責，否則即屬違法。

Under the Gas Safety (Registration Gas contractors) Regulation, Only registered gas installers (registered to the appropriate class) employed by registered gas contractors can personally carry out gas installation work. "Gas Installation Work" includes the fabrication, connection, or replacement of gas pipe work, appliances and fitting.

氣霸爐具有限公司

Hibachi Gas Cooker Limited

荃灣半山街10-16號富華工業大廈6/FB室

Factory B, 6/F., Fou Wah Industrial Bldg., No. 10-16 Pun

Shan Street, Tsuen Wan, N.T., Hong Kong.

電話Tel: (852) 2300 1357 (3 Lines) 傳真Fax: (852) 2782 6395



氣霸牌燃氣熱水爐
HIBACHI GAS WATER HEATER

使用說明書

INSTRUCION MANUAL

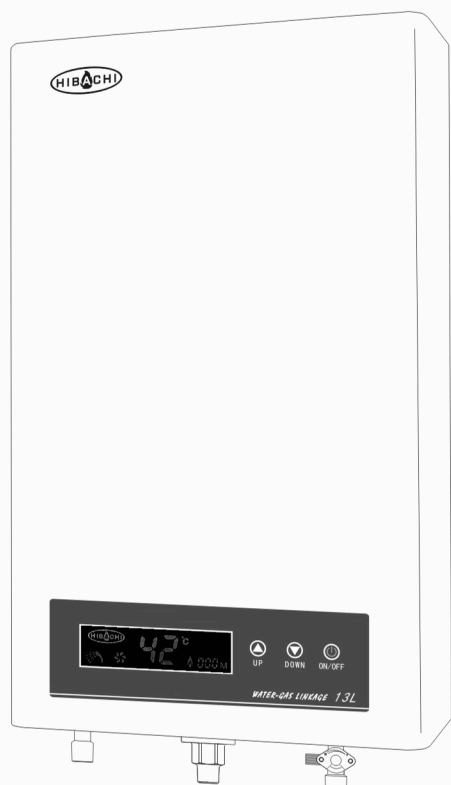

氣霸爐具有限公司
HIBACHI GAS COOKER LIMITED

型號

- HY-13TWS(頂出) 香港煤氣
- HY-13TWS(背出) 香港煤氣
- HY-13GWS(頂出) 液化石油氣
- HY-13GWS(背出) 液化石油氣

MODEL

- HY-13TWS(TOP FLUE) TOWN GAS
- HY-13TWS(BACK FLUE) TOWN GAS
- HY-13GWS(TOP FLUE) LPG
- HY-13GWS(BACK FLUE) LPG

由衷地感謝您選用“氣霸牌”對衡式燃氣熱水爐。在使用前請您詳細閱讀本說明書，正確地掌握本熱水爐的安裝和使用方法，以充分利用它的優異性能。

多謝合作！

目錄

- 用途及特點
- 外觀結構圖及尺寸
- 主要部件及名稱
- 技術性能參數
- 使用方法及注意事項
- 安裝方法及注意事項
- 檢查及維護保養
- 故障識別及處理
- 電氣接綫圖
- 售後服務
- 警告

特別警告：

本熱水器應安裝在空氣流通良好的地方，一定要使用配套的專用對衡煙管（它將燃燒廢氣排出室外，並從室外引入新鮮空氣）。必須接好電源和接好地綫方可使用。在停電或電源未接通時，請不要開啟熱水爐。如需要使用冷水時，請關閉燃氣閥門、切斷電源。請保留好說明書，以便日後查閱。

安全措施，當發覺氣體洩漏時

- 關閉氣閥。
- 打開門窗。
- 切勿開/關電源。
- 熄滅所有火種。
- 立即通知有關單位求助。
- 此熱水爐必須由註冊氣體裝置技工負責安裝。
- 註冊氣體裝置技工必須向使用者詳細說明使用方法。
- 必須遵照此說明書內所示正確使用熱水爐，以確保熱水爐功能良好。

May we take this opportunity to thank you for purchasing this "HIBACHI" balance instant gas water heater.

Before the usage, please read the instruction manual carefully, master the installation and operating method correctly, and take full advantage of the excellent performance of the water heater. Thank you for your cooperation!

CONTENTS

- Use & features
-
-
- Technical parameters
- Operating method & attention
- Installation method & attention
-
- Failure & troubleshooting
-
- After-sales service
- Warning

SPECIAL WARNING:

The water heater should be installed in well-ventilated places, and the assorted specified balance flue must be used (it discharges exhaust gas out of the room and leads in fresh air from outside into the room). Please properly connect the power and the ground wire before using it. Do not turn on the water heater when the power is cut off or before the power is on. If you need to use cold water, please shut off the gas valve and cut off the power. Please keep the instruction manual in good condition for future reference.

For safety, if you smell gas:

- Turn off the gas valve.
- Open the windows and doors.
- Do not turn on/off the power.
- Extinguish naked flames.
- Notify the concerned company for help immediately.
- The installation must be undertaken by registered gas installers.
- The registered gas installer must specify to the user how the appliance works and how to operate it.
- Properly use the water heater complying with the instruction manual to ensure the well performance of it.

產品用途

“氣霸”牌燃氣快速熱水爐採用燃氣為燃料，能快速連續地供應熱水，適合於供應熱水沐浴、洗手、洗衣及其它洗滌之用途。

特 徵

1. 燃燒充分，效率高，節約能源；
2. 水溫自動調節：先進的水氣聯動比例調節裝置水溫按預定值自動恆定（35°C-60°C）
3. 採用霍爾水流量傳感器感應水流量，超低水壓啟動；
4. 採用離子感應火焰，控制靈敏；
5. 利用低噪音變頻直流風機，強製將燃燒廢氣排出戶外；
6. 磷脫氧銅環保熱交換器，高速節能；
7. 密封燃燒室，更加安全；
8. 數碼顯示出水溫度，能自由設置出水溫度，使用戶的使用更簡單，更方便。

USE

“HIBACHI” gas water heater use gas as the fuel. It can instantly and continuously supply hot water for showering, hand washing, laundry and other cleaning.

FEATURES

1. Full combustion, high efficiency and energy conservation;
2. Automatic adjustment of water temperature, advanced water-gas linkage ratio adjustor to keep water temperature at the set value automatically (35°C-60°C)
3. With Holder water flow sensor to sense the water flow, starting with the super water pressure
4. With ion induction flame to provide the sensitive control;
5. With the low-voice and variable frequency DC fan to force out the combustion exhaust outdoors
6. With the phosphorus copper and environmental protection heat exchanger to keep the high speed with energy saving;
7. With sealed combustion chamber for better safety;
8. With the digital-display water temperature for free adjustment of the outlet water temperature to provide the simple and convenient operation for user.

外觀結構圖及尺寸 APPEARANCE STRUCTURE

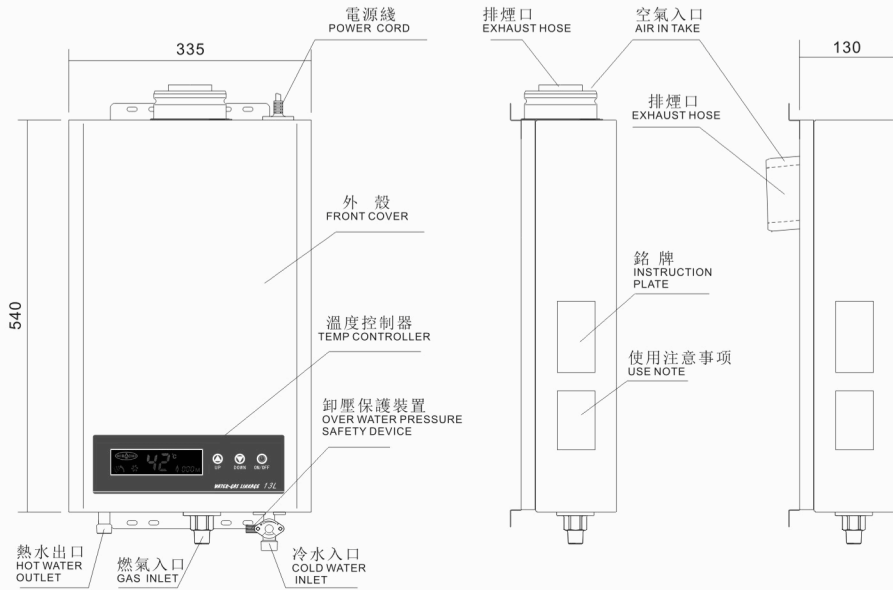

HY-13TWS(頂出TOP) HY-13GWS(頂出TOP)
HY-13TWS(背出BACK) HY-13GWS(背出BACK)



溫度控制器 TEMP CONTROLLER

主要部件及名稱 NAME OF MAIN PART

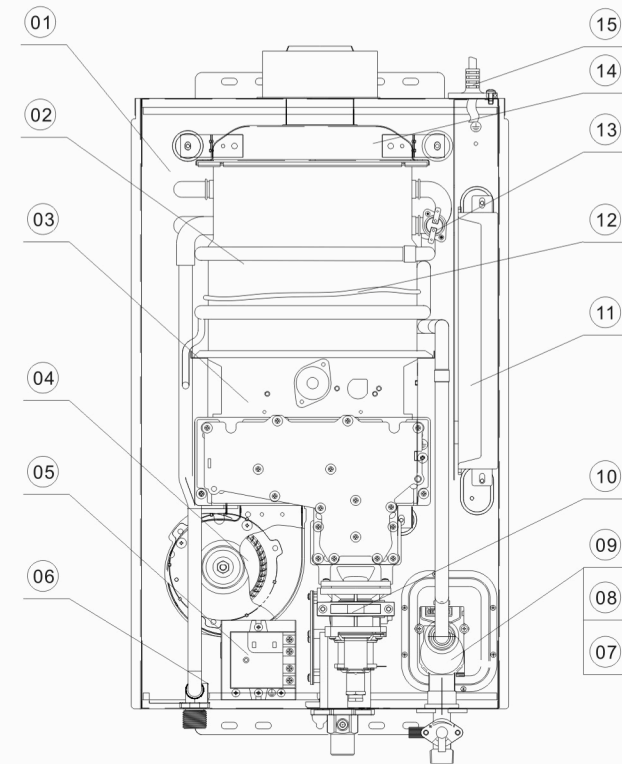

- | | |
|--------------|--|
| 01 殼體 | 01 SHELL |
| 02 熱交換器 | 02 HEAT EXCHANGER |
| 03 密封燃燒室 | 03 SEALED COMBUSTION CHAMBER |
| 04 直流風機 | 04 DC FAN |
| 05 漏電保護器 | 05 LEAKAGE PROTECTION DEVICE |
| 06 熱水溫度傳感器 | 06 HOT WATER TEMPERATURE SENSOR |
| 07 冷水溫度傳感器 | 07 COLD WATER TEMPERATURE SENSOR |
| 08 水流量傳感器 | 08 WATER FLOW SENSOR |
| 09 水量伺服裝置 | 09 WATER VOLUME SERVO DEVICE |
| 10 燃氣比例閥 | 10 GAS PROPORTIONAL VALVE |
| 11 CPU中央控制器 | 11 CPU CENTRAL CONTROLLER |
| 12 防止燃燒室損傷裝置 | 12 COMBUSTION-CHAMBER DAMAGE PREVENTION DEVICE |
| 13 防干燒保護裝置 | 13 ANTI-DRY BURNING PREVENTION DEVICE |
| 14 集煙罩 | 14 SMOKE COLLECTION COVER |
| 15 電源線 | 15 POWER CORD |

技術性能參數

產品名稱	強製對衡式 密封燃燒室 燃氣熱水器			
產品型號	HY-13TWS		HY-13GWS	
給排氣方式	頂出 強製給排氣式	背出 強製給排氣式	頂出 強製給排氣式	背出 強製給排氣式
控制方式	後制式			
點火方式	自動連續脈沖點火方式			
外形尺寸	寬335mm×高540mm×厚130mm			
重量	14.5公斤			
最低啟動水壓	0.02MPa			
最低啟動水流量	2.5L/min			
適用工作水壓	0.02-1.0MPa			
額定產熱水能力	13升/分鐘(溫升25K)			
額定熱負荷	28kW			
額定電壓	AC220V 50Hz			
額定電功率	35kW			
連接方式	冷水入口	G1/2		
	熱水出口	G1/2		
	燃氣入口	G1/2		
適用燃氣種類	香港人工煤氣	液化石油氣		
額定供氣壓力	1.5kPa	2.9kPa		
安全保護裝置	意外熄火安全保護裝置			
	防止燃燒室損傷安全保護裝置			
	殘火燃燒安全保護裝置			
	防燙傷安全保護裝置			
	防漏電安全保護裝置			
	防水壓過高安全保護裝置(OFF:1.0MPa;ON:1.6MPa)			
	電路保險絲(2A)			

TECHNICAL PARAMETERS

NAME	FORCED AIR INTAKE & EXHAUST SEALED COMBUSTION GAS SAFETY WATER HEATER			
MODEL	HY-13TWS		HY-13GWS	
FLUE TYPE	FORCED AIR INTAKE & EXHAUST TOP BALANCED FLUE	FORCED AIR INTAKE & EXHAUST BACK BALANCED FLUE	FORCED AIR INTAKE & EXHAUST TOP BALANCED FLUE	FORCED AIR INTAKE & EXHAUST BACK BALANCED FLUE
CONTROL MODE	WATER FLOW CONTROLLED POST BRAKE			
IGNITION MODE	AUTO. CONTINUOUS ELECTRIC SPARKING			
DIMENSIONS	W335mm×H540mm×D130mm			
WEIGHT	14.5kg			
MINIMUM WATER PRESSURE	0.02MPa			
MINIMUM WATER FLOW	2.5L/min			
APPLICABLE WATER PRESSURE	0.02-1.0MPa			
HOT WATER SUPPLY	13Litres/min (rise25K)			
GAS CONSUMPTION	28kW			
OPERATING VOLTAGE	AC220V 50Hz			
RATED INPUT POWER	35kW			
CONNECTION	COLD WATER INLET	G1/2		
	HOT WATER OUTLET	G1/2		
	GAS INLET	G1/2		
GAS TYPE	TOWN GAS		LPG	
TATED GAS PRESSURE	1.5kPa		2.9kPa	
SAFETY DEVICES	FLAME ROD SAFETY DEVICE			
	OVERHEAT PROTECTION SAFETY DEVICE			
	HIGH LIMIT SWITCH			
	AUTI-SCALD DEVICE			
	ELECTRIC LEAKAGE PREVENTION DEVICE			
	OVER WATER PRESSURE DRAIN (OFF: 1.0MPa;ON:1.6MPa)			
	POWER FUSE (2A)			

使用方法及注意事項

1. 溫度控制器的使用說明：

① 電源開關鍵；

② 升溫鍵，調整出熱水溫度，按下此鍵，

設定溫度上升1℃；

③ 降溫鍵，調整出熱水溫度，按下此鍵，

設定溫度下降1℃；

④ 設定溫度顯示屏，顯示用戶設定的溫度值；

⑤ 水流指示燈，打開水龍頭，此指示燈動態顯示；

⑥ 風機運轉指示燈，裝置風機運轉時，此燈動態顯示；

⑦ 燃燒指示燈，著火燃燒時，此燈點亮，否則不亮；

⑧ 時間指示：顯示連續使用熱水爐的時間，重新啟動時，時間亦重新開始累積計算。

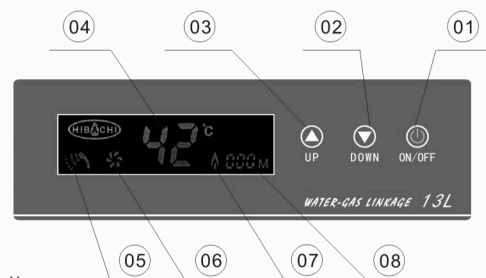

2. 溫度調節範圍：

35 36 37 38 39 40 41 42 43 44 45 46 47 48 49 50 55 60

清潔碗碟溫度

淋浴溫度

浴缸溫度

高溫

3. 熱水爐的使用：

3.1 操作前的準備和確認

接通電源；按下操作器上之電源開關鍵；

打開燃氣氣閥；

打開出水水龍頭。

3.2 熱水器着火與出熱水

當熱水龍頭或花灑開啓後，有水流動時，熱水爐自動點火；水時，爐火會自動熄滅，氣閥也自動關閉。可從熱水器溫度控制器上察着火時“燃燒”燈是否亮起；不着火時，“燃燒”燈熄滅。當開始使用時，檢查有無亮燈，輸出熱水是否正常。

● 注意：安裝後第一次使用或長時間沒有使用熱水爐，需多次進行上述操作行為直到排出燃氣氣管內全部空氣后才能點著火。

3.3 熱水溫度的選擇與調節

按下溫度控制器上的“升溫”“降溫”鍵，便可調節熱水溫度。從35℃-50℃，每按壓1次

OPERATING METHOD & ATTENTIONS

1. Temperature Controller Introduction:

① Power: to open and close

② Up: to rise the outlet water temperature, 1℃ up with each press

③ Down: to lower the outlet water temperature, 1℃ down with each press

④ Temperature Screen: to display the set temperature value

⑤ Water-flow indicator Light: to light when the faucet is turned on

⑥ Fan Running Indicator Light: to light when the fan is running

⑦ Burning Indicator Light: to light when the fire is burning

⑧ Time Indicator: to display the time of continuous use (The time will be recalculated when it is restarted.)

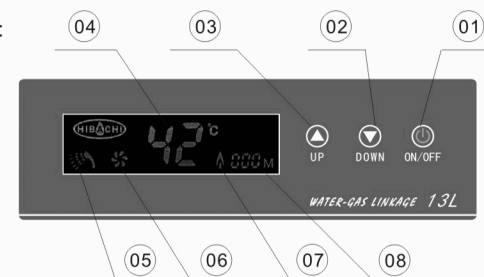

2. Range for Temperature Adjustment:

35 36 37 38 39 40 41 42 43 44 45 46 47 48 49 50 55 60

WASH TEMP

SHOWER TEMP

BATHTUB TEMP

HIGH TEMP

3. Use of Water Heater:

3.1 Preparation and Confirmation before Operation

1) Connect to power supply, Press "Power" Key for opening

2) Turn on gas value

3) Turn on water faucet

3.2 Water Heater On-fire and hot-water flowing

When the hot water faucet or shower is opened, the water flows out and Water Heater is ignited automatically; when the hot water faucet or shower is closed, the water is stopped and Water Heater is closed automatically. The dynamic change can be observed by Water Heater Temperature Controller: "Burning" light is on when it is firing and "Burning" light is off when it is closed. Please check the lighting status and if the hot water is normal in the starting use.

● Remark: Please operate the above steps several times to make sure all air in the gas pipeline has been discharged so that it could be fired in the first use or re-use after long-time.

3.3 Selection and Adjustment for Hot Water

Press "Up" or "Down" key in Temperature Controller to adjust. In the range of 35℃-50℃; 1℃ is adjusted by each press;

使用方法及注意事項

升温或降温1℃；從50℃-60℃，每按壓1次，升温或降温5℃。在溫度顯示屏上，清楚顯示熱水溫度。(熱水溫度應用範圍，請按2條款的說明選擇。)

3.4 熄火及關閉熱水

當關閉熱水龍頭時，熱水爐自動熄火，內置風機將進行後清掃工作，運行數秒後停止。

當輸出熱水流量小於2.5升/分鐘時，熱水爐也會自動熄滅，關閉氣閥。

3.5 停水、停電時的處理

如遇暫時停止供水時，請關閉熱水龍頭及燃氣閥門。

如遇暫時停電時，請記住關閉熱水龍頭、燃氣閥門及電源開關。

長期不用時，請關閉燃氣閥門及電源開關。

3.6 冬季預防結冰

當氣溫下降至零度以下時，為防止冷水結冰會導致熱水爐水管破裂，漏水及不能使用。

請採用下列方法處理：

方法一：

關閉燃氣閥門，擰開少許熱水龍頭（水流量約為200毫升/分鐘），讓水慢慢流盡。

方法二：

關閉燃氣閥門，進水總閥門，擰開水壓安全閥，打開全部冷熱水龍頭，放低花灑，讓熱水爐內的全部積水流盡，確認無存水後重新將水壓安全閥及水龍頭關閉。

方法三：

如遇有少許凍結發生，則注意將冰溶解為水後，讓水放盡，檢查熱水器內水管有無異常後，才可使用熱水爐。

已安裝防凍裝置的熱水爐，在冬季低溫環境下使用時，請記住千萬不可關閉電源開關鍵。熱水爐內，防凍傳感器檢測到水溫可能會凍傷水管時，自動加熱系統將開始工作，確保水管不被凍傷。

OPERATING METHOD & ATTENTIONS

In the range of 50℃-60℃, 5℃ is adjusted in each press. The set temperature of the hot water is clearly displayed in the temperature screen (For the range of hot water, please refer to the description in Point 2.)

3.4 Turn-off of Fire and Hot Water

1) When the hot-water faucet is closed, the water heater will be closed automatically. Inside fan is operating clean process and will be stopped within several minutes.

2) When the value of outlet hot water is less than 2.5L/minute, the water heater will be closed automatically and the gas value is closed

3.5 Shut-off of Water and Power Handling

1) When the water is stopped temporarily, please close the hot water faucet and gas value

2) When the power is stopped temporarily, please close the hot water faucet, gas value and power switch

3.6 Water-freezing Prevention in Winter

When the temperature drops to below zero, in order to prevent the water from freezing, which will cause the hot water boiler pipe burst or leaking so that the heater could not be used, please use the following methods:

1) Method 1: Turn off the gas value, turn on the hot water faucet a little (water volume is about 200ML/minute), let the water flow out slowly

2) Method 2: Turn off the gas value and the inlet water value, press water-pressure safety value, turn on all hot and cold water faucet, lower the shower to let the water inside the water heater flow out. Re-close the water-pressure safety value and the water faucets when you are sure there is no water inside

3) Method 3: If there is a little freezing, please have the ice dissolved into water, let the water flow out and check if there is any abnormal inside the hot water pipes before you use the water heater.

For the water heater which has been installed with the freezing prevention device, when it is used in the low temperature in winter, you must not turn off the power as the auto-heating system with the freezing-prevention sensor inside will sense that the water is too cold to the pipes and start the heating to prevent the pipes from damage.

4. 使用注意事項

4.1 預防漏氣

使用後一定要將燃氣閥門關閉。

4.2 禁止火災

禁止放置易燃物品及易揮發性物品在熱水爐周圍。

禁止放置毛巾，抹布等易燃品在排氣口和供空氣口上。

禁止開啓熱水爐後外出或睡覺。

4.3 預防燙傷

間斷使用時，要注意最初流出來的熱水溫度，以免燙傷。

使用中以及剛使用完成後，器具本身的溫度較高，所以除按鈕以外，不要用手觸摸其他部位。

4.4 事故的預防

當你嗅到燃氣臭味時，應立即將燃氣閥門關閉，打開門窗，讓燃氣排走，此時切勿開關電掣並不準打開熱水爐進出水閥門。事後一定要查明原因，並與維修部或煤氣安裝公司聯系處理。

在使用過程中遇到中途停電或沒有接通電源，請先關閉出水閥門，待來電或接通電源後打開熱水閥門。

不得隨便打開面殼和拆卸旋鈕，以免損傷密封元件。若密封元件損壞，可以向當地特約維修站聯系。

4.5 發生異常燃燒或其他緊急情況時的處理

萬一發生異常燃燒或其他緊急情況，不要慌張，應立即關閉燃氣閥門。

在使用過程中，萬一感覺有異常的異味時，應馬上停止使用，與給維修部和煤氣安裝公司聯系處理。

4. Use Notes

4.1 Leaking Prevention

Gas valve must be turned off after use

4.2 Fire Prevention

1) Flammable and volatile substances are prohibited around the hot water heater

2) Towel, rags and other flammable materials are prohibited to be placed in the exhaust port and the air supply port

3) Go-out and sleeping is prohibited when the water heater is working

4.3 Scalding Prevention

1) Pay attention to the temperature of the flow-out water at the beginning in discontinuously use of the heater water

2) In use and after the completion of the use, the temperature of the heater is high. So in addition of the button, do not touch other parts of the heater

4.4 Accident Prevention

1) When you smell the gas, you should immediately turn off the gas valve; open the doors and windows to let the gas discharged. At the same time, you must not turn on the electrical switches and the water valves of the heater. Afterwards, you must find out the causes and contact with Maintenance Department or Gas Installation Company for handling.

2) If the power is stopped in the use or there is no connection to the electricity, please turn off the water valves first and re-turn on the hot water value when the electricity is normally.

3) Do not open the surface shell and remove the knob in case the sealed elements are damaged. If the sealed elements are damaged, please contact with local contracted Maintenance Stations for assistance.

4.5 Handling for Abnormal Combustion and other Emergencies

1) In the face with the abnormal combustion or other emergency situation, please keep calm and turn off the gas valve immediately.

2) When you smell the abnormal odors, you must stop the use immediately and contact with Maintenance Department or Gas Installation Company for handling.

使用方法及注意事項

4.6 下列情況是正常情況，不當作故障處理

最低使用水壓

該熱水爐是感知水流量大小來確定開關燃氣閥門的，當水壓低於最低動作水壓時，水流量低於2.5L/min，系統不打開燃氣閥門。這屬於正常現象。

熱水出現白濁現象

若看見熱水出來後呈白濁現象，一會兒就變透明，這是由於溶進水中的空氣加熱後增壓而放水時急速減壓而出現小氣泡所致。

4.7 不得使用供應飲用水

由於熱水器內長期有積水，所以本熱水器所供應的熱水不能作為飲用水，祇能作一般衛生用水。

4.8 使用硬水時

使用硬水時，熱水會在器具內形成水垢，從而增加水流阻力，損害該熱水爐性能，降低熱效率。為減少水垢，理時使用時可按下面方法處理：用完熱水器後，關閉燃氣閥，讓熱水器內的熱水全部流出來，待供熱水龍頭流出冷水後，關閉冷水龍頭。

4.9 預防漏水

在使用熱水爐後，一定要將供冷水閥門關閉。

4.10 本必須使用原裝的電源綫，使用前本機必須可靠接地，使用220V/50Hz交流電源，以確保使用安全性。

OPERATING METHOD & ATTENTIONS

4.6 The following situation is normal, do not handle them as failure:

1) Minimum Water Pressure

The water heater will sense the water volume to decide if the gas valve is turned on or not. If the water pressure is lower than the minimum water pressure (The water flow is less than 2.5L/minute), the system could not turn on the gas valve. This is a normal situation.

2) Hot Water with white bubbles

If you see the water is clouding phenomena and becomes transparent. They are the small bubbles caused by the dissolved air in the water when it is heated with pressurization and drainage rapid decompression.

4.7 Do not Use as Drinking Water

Because there is water inside the water heater all the time, the hot water supplied by the water heater can not be used as drinking water and it could only be used as a general sanitary water.

4.8 Use of Hard Water

In the use of hard water, the scale will be formed in the container, which will increase the water flow resistance to damage the heater performance and influence the thermal efficiency. In order to reduce the scale, please operate as following method: after the use of the water heater, turn off the gas valve to let the inside hot water flow out; close the cold water faucet after all hot water inside the heater flows out completely.

4.9 Water Leaking Prevention

Please turn off the cold water value after the use of the water heater

4.10 The original power cords must be used. Keep the machine connected to the reliable grounding and use 220V/50Hz AC Power Supply to ensure the safety use.

安裝方法及注意事項

特別注意：

燃氣熱水爐的安裝使用對安全性有很大影響，故此請特別注意以下事項：

- 應使用該熱水爐銘牌上所標明的適用燃氣種類，其他燃氣禁止使用。
- 不得用于供熱水以外的其他用途。
- 將熱水器安裝在空氣流通的地方。
- 使用所配置的烟道，按說明書要求進行安裝後才能使用。
- 不得將熱水爐安裝在距離可燃物太近的地方，排烟口附近不允許有可燃物品。
- 請勿將熱水爐安裝在燃燒器具的上面。
- 非專業人員不得拆卸面殼，以免損傷密封件。
- 請勿將熱水爐安裝在危險棚架下面或窗簾及易燃物旁邊。
- 請按要求連接地綫，勿將地綫與氣管相連接。
- 請勿安裝在儲藏易燃危險品場所附近。使用熱水爐的室內請不要存放或使用易燃品和易揮發性的物品。
- 請勿在灰塵多的地方安裝或使用熱水爐。
- 熱水爐的上部不允許有電力明綫、電氣設備。
- 熱水爐與電器設備的水平距離應大于400mm。
- 烟道的安裝如圖所示，烟道防風管表面帶孔部分必須伸出牆外不小于100mm。不要堵塞或阻礙烟道的排氣或進氣。
- 電源綫不得接觸排氣裝置外殼，以免高溫損壞電源綫的絕緣層。

INSTALLATION METHOD & ATTENTIONS

Special attentions:

The installation and operation of the instant gas water heater have a great influence on the safety, therefore, please pay special attention to the following matters.

- Only the type of gas marked on the rating label of the water heater should be used.
- The water heater should not be used for other purpose other than hot water supply.
- Install the water heater in well-ventilated places.
- Do not use the waer heater until the assorted flue is installed according to the instruction manual.
- The water heater can not be installed too near combustibles. And there can not be any combustibles near the exhaust vent.
- Do not install the water heater above burning apparatuses.
- The front panel can not be removed by anybody except professionals, so as not to damage the sealing elements.
- Do not install the water heater under dangerous shelves or near the curtain or inflammabe.
- Please properly earth the water heater according to the relevant requirements and do not connect the earth lead with the gas pope.
- Do not install the water heater near where inflammable dangerous goods are stored. Do not store or use inflammable and volatile goode in the room where the water heater is used.
- Do not install or use the water heater in dusty places.
- There can not be exposed electric line or electric appliances above the water heater.
- The horizontal distance between the water heater and electrical appliance should be more than 400mm.
- The installation of the flue is shown as the drawing. The section with holes on the windproof pipe of the flue should extent out of the wall for at least 100mm. Do not block or obstruct the exhaust or inlet of the flue.
- The power crd shouldn't contact the housing of the exhaust device, so as to prevent the insulation layer ofthe power cord from being damaged due to high temperaure.